

PRODUCT INFORMATION MODEL 0318 BABOO

© 2018 KURT BEIER & KATI QUINGER



Functional chair with two, one or ...



...without armrest(s) and 360° rotary function



Simple handling by sensor buttons

**BABOO:** RELAX, BEING AT PEACE WITH YOURSELF, CHANGING PERSPECTIVE. PURISTIC LOUNGE CHAIR WITH 360° SWIVEL FUNCTION. TOUCH SENSORS ENABLE SMOOTH AND INFINITE ADJUSTMENT OF SEAT AND BACK SECTION. HEADREST MANUALLY ADJUSTABLE. STEEL BASE PLATE, STRUCTURE COATED OPTIONALLY IN BLACK OR, FOR AN EXTRA CHARGE, IN COLOUR OR WITH STAINLESS STEEL COVER. COVERS IN FABRIC OR LEATHER, DIFFERENT SEAM TYPES AVAILABLE. TWO SEAT WIDTHS, WITH OR WITHOUT ARMRESTS. AVAILABLE WITH BATTERY (IMAGE) OR CABLE CONNECTION.







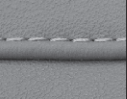
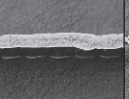

**Lower frame, armchair:** rotary system optionally with

- base plate, round (ø 60 cm) or square (60 x 60 cm), made of metal, powder-coated fine structure in black matt, optionally (at extra charge) in the colours terracotta, grey-blue, eucalyptus or pebble grey.
- base plate made of metal with stainless steel cover (extra charge)

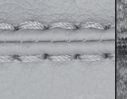
**Attention! maximum load, rotary system:** up to 120 kg

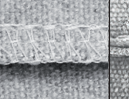
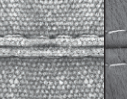
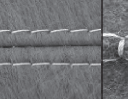
### Processing options of main seam / decorative seam

	Plain seam	Lap seam	Raw edged	Moccasin seam extra charge	Twin seam extra charge	KR* (zipper piping) extra charge	Overcast seam extra charge	Piping	Two needle seam	Square seam extra charge
										
<b>Fabric</b>	x					x	x	x		
<b>Leather</b>	x		x			x		x		
<b>Fur</b>	x									

It is possible to order main seam or decorative seam either tone in tone like the colours of cover or in the contrasting colours white, nature, grey, rust and black. On request special colours possible.

\*Zipper piping: optionally in the colours black, red, nature or light grey.



BASE PLATE, ROUND

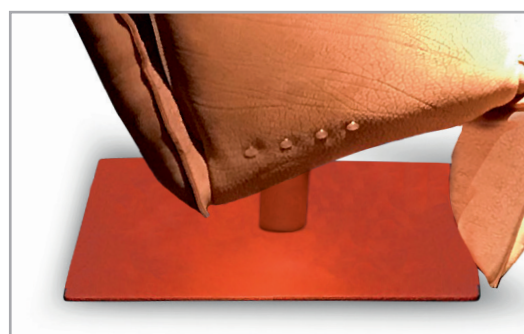

BASE PLATE, SQUARE

25.05.2021

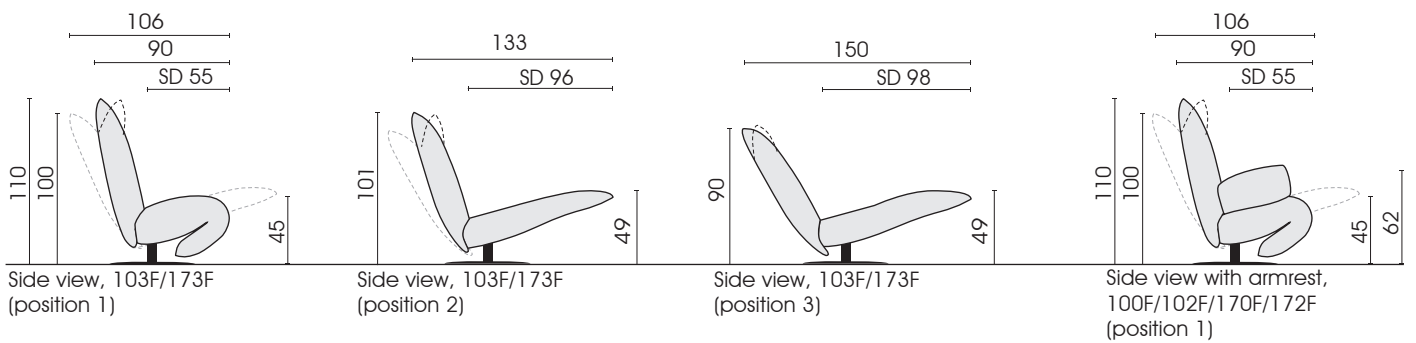

SD = Seat depth □ = Label

Chair, narrow

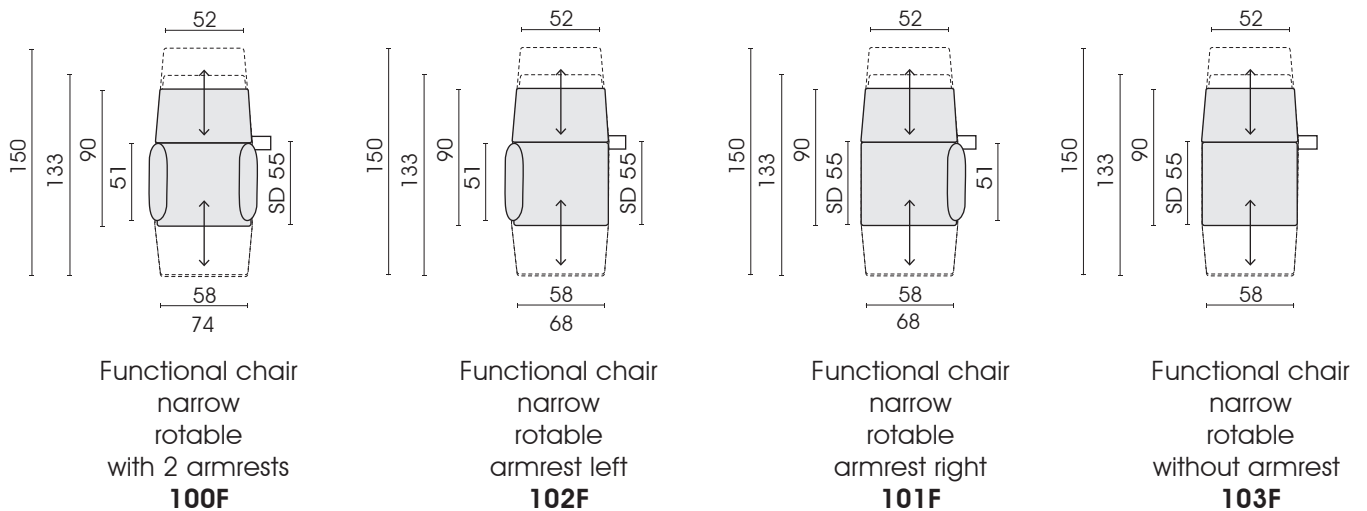

Functional chair  
narrow  
rotable  
with 2 armrests  
**100F**

Functional chair  
narrow  
rotable  
armrest left  
**102F**

Functional chair  
narrow  
rotable  
armrest right  
**101F**

Functional chair  
narrow  
rotable  
without armrest  
**103F**

Each piece of furniture is handmade and unique. Deviations to the listed measurements may be caused by:  
1. different upholstery materials (fabric, leather), 2. processing of ticking mats, 3. the pressure to combine individual parts, etc.  
The seat comfort of a sofa type with larger seat depth usually differs from one with lower depth.

SD = Seat depth □ = Label

Chair, wide

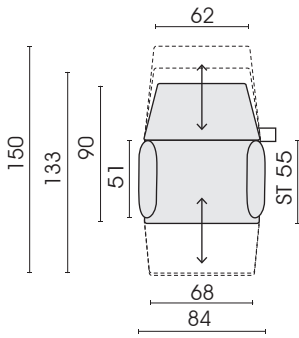

Functional chair  
wide  
rotable  
with 2 armrests  
**170F**

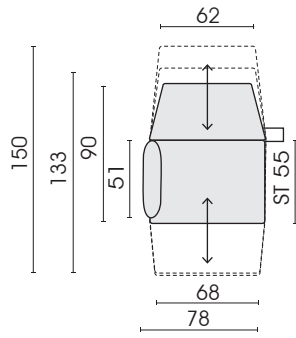

Functional chair  
wide  
rotable  
armrest left  
**172F**

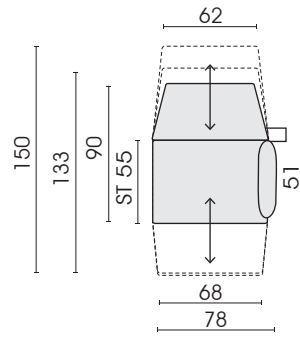

Functional chair  
wide  
rotable  
armrest right  
**171F**

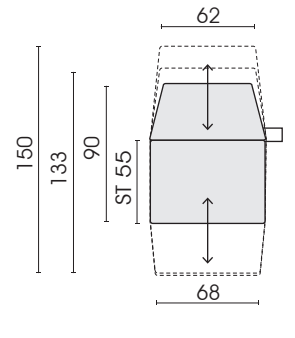

Functional chair  
wide  
rotable  
without armrest  
**173F**

**Standard version for motorised drive:**

- touch it
- power supply

**Optionally with battery for an extra charge.**

Consistent with table 8163

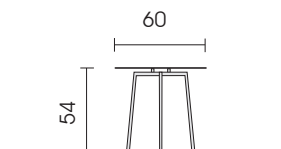

**Lower frame:** round pipe metal  
matt black fine structure  
powder- coated

**Plate:** metall. matt black  
fine structure powder- coated



round table  
with metal plate,  
fine structure  
matt black  
**T47**

Each piece of furniture is handmade and unique. Deviations to the listed measurements may be caused by:  
1. different upholstery materials (fabric, leather), 2. processing of ticking mats, 3. the pressure to combine individual parts, etc.  
The seat comfort of a sofa type with larger seat depth usually differs from one with lower depth.